



GLADTECH 2025

May 21st & 22nd

Gladwin's Missouri office will again be hosting a customer event, featuring live-demoing of the latest in fabrication equipment from the worlds leading manufacturers - including several automation applications and multiple seminars!

8:30am - 4:00pm each day

Always
Solving

Daily Robotic Welding Seminars

8:30am & 12:30pm

How to get into robotic welding,
new technologies, and alternatives to sub-arc welding.

BBQ lunch each day!

Accurpress

Great range of hydraulic press brakes
with impressive features & options.

LIVE DEMOS



GLADWIN

Automation Division

- 55 Ton Safan E-Brake with integrated Fanuc robot
 - Robotic bending solution for any size project.
- "Custom is Standard"



KOHLER

Precisely level and relieve stress from sheets and part blanks. Your downstream production processes will benefit from higher quality flat parts reducing forming, fixturing and welding times dramatically. All while providing better finished parts!

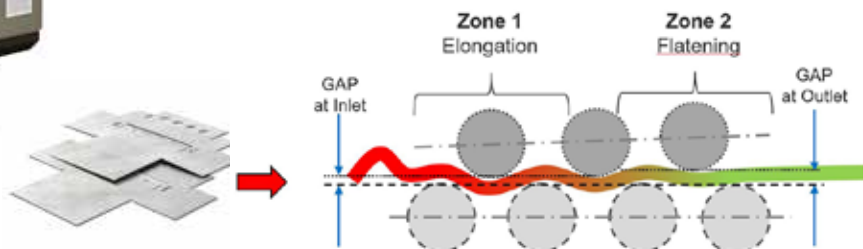

GLADWIN

Machinery Solutions, LLC



DAIHEN Inc.

- (3) Robotic cells under power and running parts
- OTC The Global Leader in Robotic Arc Welding
- Entire welding solution is OTC! Welder, robot, material handling....ALL OTC



ECO-ARC 290



Accelerate your welding processes by creating jigs and fixtures faster.

LIVE DEMOS

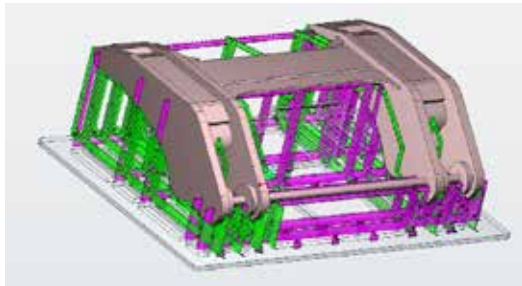

The ULT Airtower for welding fume extraction with NO DUCTWORK



High-performance industrial dust collectors come in many makes and models and are built with features to stand up to your rugged manufacturing environment.

Register for the show!



GLADTECH 2025
May 21st & 22nd

Mazak

OPTONICS CORP.

- The next generation of high power fiber lasers with maximum control.

LIVE DEMOS

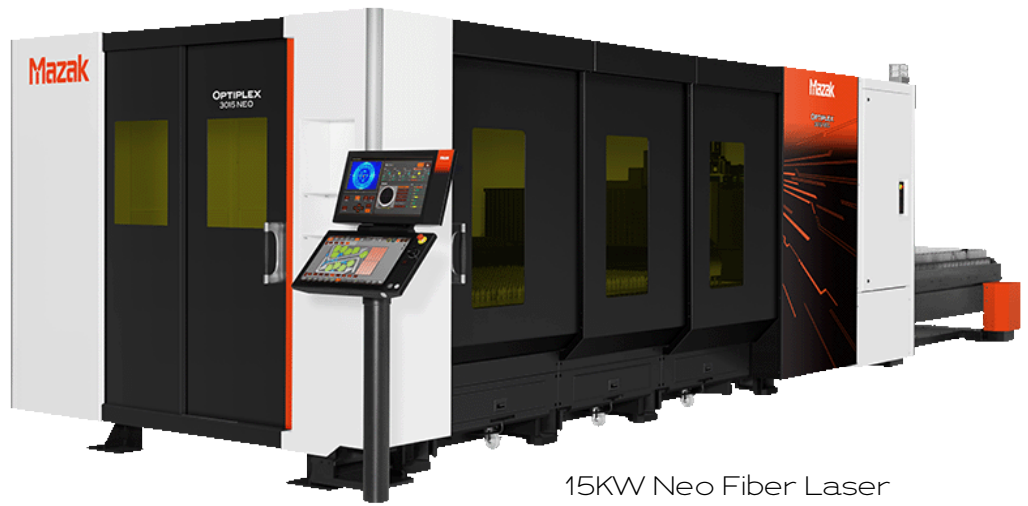

15KW Neo Fiber Laser



Liberty nitrogen generators, mixers and high performance air systems.



RADAN BY  **HEXAGON**

Vertically integrated software.

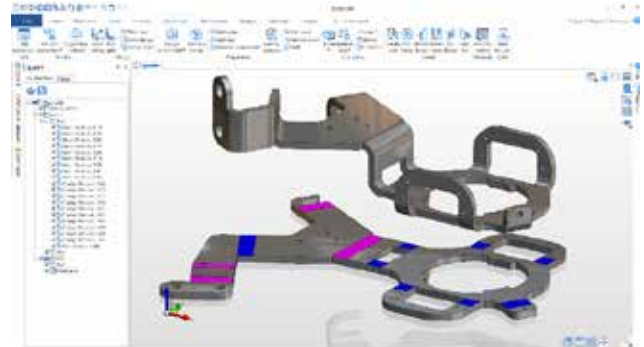

WILA
SINCE 1932
THE PRESS BRAKE PRODUCTIVITY PEOPLE
Precision tooling and clamping systems



130-3100 Ultra

 **SAFAN[®] DARLEY**
The E-volution in sheet metal working

- Multiple Safan electric press brakes
- Safan R-Brake



R-Brake



- The most complete line of vertical saws in the industry.
- Full line of horizontal saws from both Marvel and Amada.



8-Mark-III



380 Automatic Saw

LIVE DEMOS



Blaze Mobile



Blaze Duo

OB7 Collaborative Robots from Productive Robotics are the simplest and most flexible cobots for automating thousands of industrial production tasks across all industries.



32 WRB Series

- 32 Series rotary brush machine offers deburring, edge rounding, oxide removal and slag removal on one machine.



- Discover the E.P.I.C. advantage – Best in Class.
- Long bed vertical machining centers.
- 10' - 50' long, up to 10' wide.



FlexCNC



DAVI

First completely electric plate roll series in the world.

SEE FOR THE FIRST TIME IN KANSAS CITY

CNC Electric Plate Roll

SCHRÖDER GROUP

- Bi-Direction up/down bending makes forming easier.
- Automated systems with automatic tool changing and part handling.



PowerBend Professional
CNC Bi-Directional Folding

LIVE DEMOS

TECOI

Advanced Plate Processing Systems

TECOI's THOR is the most versatile plate processing station on the market, allowing the production of parts with multiple operations such as milling, drilling, tapping, countersinking, marking, etc.

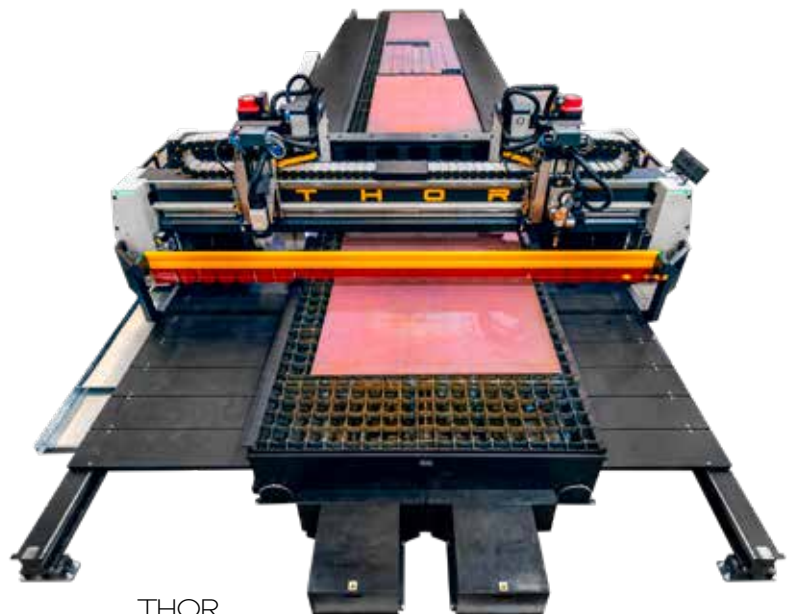

THOR

GLADWIN
Machinery Solutions, LLC

LEMAS®

- Reliable Economical 3 and 4-Roll Hydraulic Plate Rolls.
- Standard productivity enhancing features.



LEMAS TR Series

LIVE DEMOS



Aluminum Saw



- Full range Manual and Semi-Automatic Miter Band-saws
- High Speed Aluminum Saws and Machining Centers



Register
for the show!



Manufacturers Capital will be onsite to answer all your questions regarding equipment financing.



Messer Cutting Systems is a global supplier of cutting solutions for the metal-working industry. As the leader in the thermal cutting industry, we are working on smarter, faster, and reliable solutions as an added value for our customers.

GLADTECH 2025
May 21st & 22nd



***Always Solving.
For Over 50 Years!***



★ **Minnesota**

(MN, ND, SD)
5170 Main Street N.E.
Minneapolis, MN 55421
763.574.900

★ **Wisconsin**

(WI, Upper MI)
W167 N5905 Greenway Circle
Menomonee Falls, WI 53051
262.703.0400

★ **Kansas City**

(W. IA, MO, NE, KS, S. IL)
16203 North West 45 Highway
Parkville, MO 64152
816.777.5999

★ **Illinois**

(E. IA, IL, IN, MI)
636 East State Parkway
Schaumburg, IL 60173
847.490.3500

Also your trusted source for buying and selling used fabrication equipment!
www.gladwinmachinery.com